

简单故障处理

故障现象	故障原因	排除方法
电源指示灯不亮	1.电池无电 2.电源线未插好	1.电池是否已正常安装 2.请检查电源线连接正常
耳机或音响没声音	1.电源没连接 2.耳机或音响音量没调好 3.连接插孔不正确	1.请检查音源线 2.设备是否已调节音量 3.检查插孔是否插好

注意事项

- 1.在使用外部设备输入音源时请注意文件的格式。
- 2.请不要将本电子鼓置于过热或灰尘过多的地方工作。
- 3.在播放时, 请注意与收音机、电视机等强电磁仪器保持距离, 以免产生干扰。
- 4.勿将重物放在电子鼓上, 避免冲击碰撞。
- 5.请不要将本电子鼓放在潮湿或过热的地方, 以免损坏。
- 6.请不要将本电子鼓以90°或大角度的折叠挤压, 以免损坏。
- 7.不要将尖锐的物件与本电子鼓共存或碰撞, 以免损坏。

产品规格:

- 1.产品尺寸: 39(L) × 28(W) × 2.6(H)CM
- 2.输入电压: USB 5V(电池: AAA × 1.5V × 2PCS)
- 3.材质: 硅胶

7

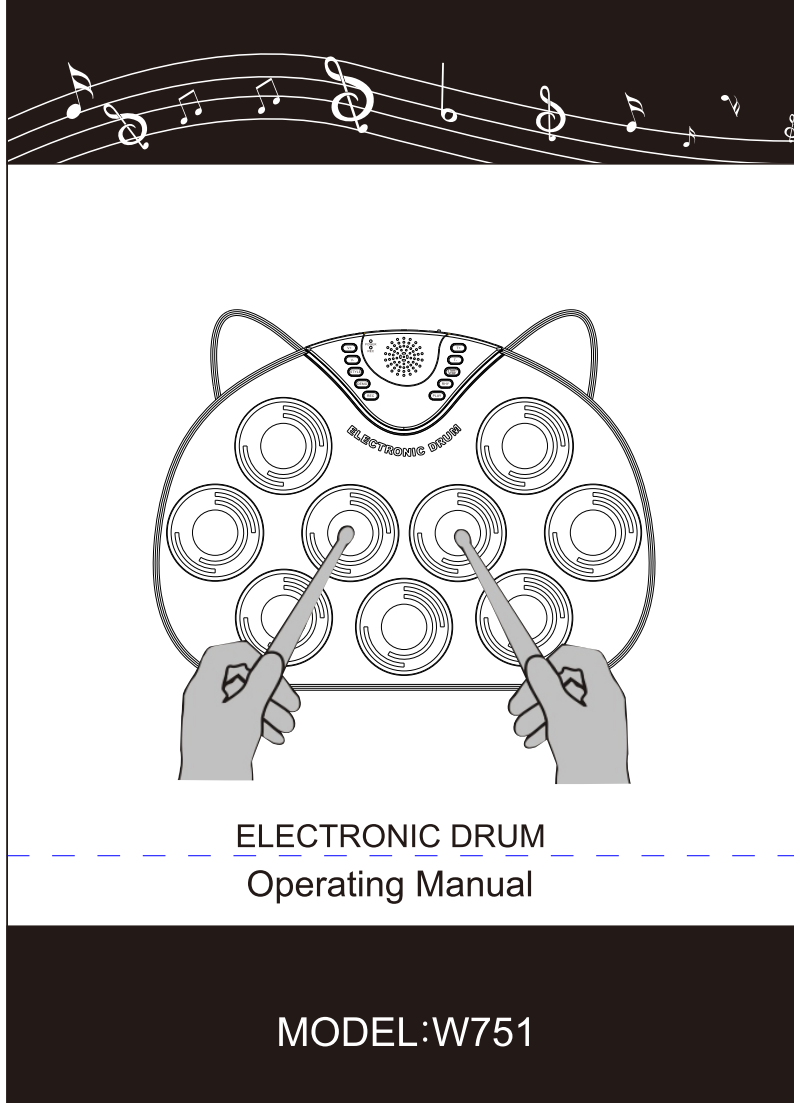

ELECTRONIC DRUM
Operating Manual

MODEL:W751

Dear customer:

Thank you for choosing this hand roll electronic drum. This stylish portable Drum Kit using modern science technology and electrical industry innovation design, it's a result of our persevered work.

We sincerely hope that it will give full play to your musical talent, and bring your immense joy and wonderful experience.

Electronic drum Overall Appearance

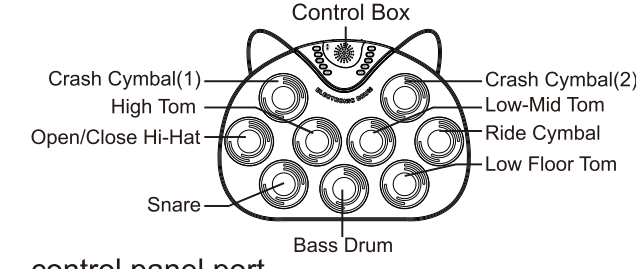

control panel port

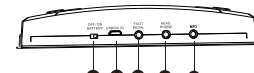

1. Battery power Switch
2. DC 5V/ USB Port
3. Pedal interface
4. Audio output interface
5. Audio input interface

Before using this product, please read the instruction sheet carefully

1. Please install 2*AAA battery or connect computer before use.
2. Shall be connecting loudspeaker or earphone to get sound before use.

1

控制面板基本操作

一. 调节音量 V+ / V-
按下音量V+ / V-键可以放大或减小音量。

二. 速度 T+ / T-
按下T+ / T-键可以加快或减慢示范曲以及伴奏曲播放的速度

三. 鼓组STYLE

按下style键, 可以循环切换7组不同的鼓组, 然后敲击鼓面会发出不同的鼓声。

四. 示范曲DEMO

按下Demo键, 可以循环切换12组示范曲, 如需停止请按一次START/STOP键

五. 录制REC

按下REC键, RECK灯闪烁, 表明可以开始录制; 再次按REC键, 即停止录音, RECK灯熄灭(如需继续录制, 请再次按REC键, 但前面录音会消失)。注意(DEMO或RHY键工作时, 按REC或PLAY键将不会工作)

六. 播放录音PLAY

按下PLAY键, 可以播放录制的音乐, 需停止请按START/STOP键。

七. 播放伴奏RHY

按下RHY键, 可以循环切换播放9组RHY伴奏, 停止请按START/STOP键。

八. 开始/停止START/STOP

按下START/STOP键, 默认播放RHY伴奏, 并且可以停止正在播放的DEMO曲及RHY伴奏。

6

控制面板端口基本操作

一. 电池开关ON/OFF BATTERY

1. 使用电池打开电池盖, 装入有效的2节AAA号电池, 并注意正负极即可。
2. 将ON/OFF BATTERY开关推至ON的位置(注意此开关只控制电池供电)。

二. 电源接口USB/DC5V

1. 可USB直接供电或者电源适配器供电。
2. 由于电源是选配件, 电源适配器其参数为直流输出电压5.0V。

※ 本电子鼓既能使用电池, 也能使用USB供电及选配的电源适配器供电。

注意!

1. 电池电量不足请更换电池。
2. 长时间不使用电子鼓时, 请将电池取出, 避免电池漏液或损坏。
3. 当电子鼓使用电源时最好取出电池, 以免损坏其性能。

三. 踏板输入

1. 本鼓支持一个HI-HAT踏板和底鼓踏板作为触发源, 两个踏板均为单声道输入;
2. 当脚踏没有接入FOOT PEDAL接口时, 敲打HI-HAT鼓盘发CLOSE(闭脚)的声音; 当把脚踏插头接入本鼓背面的FOOT PEDAL接口时, 踩下脚踏踏板时, 敲打合踩脚踏盘时发CLOSE(闭脚)的声音; 没有踩下脚踏时, 敲打鼓盘发OPEN(开脚)的声音;
3. 将脚踏插入本鼓背面的FOOT PEDAL接口时, 其中一个脚踏为底鼓功能, 踩下脚踏, 发出底鼓声音, 松开不发声

四. 耳机/音响插孔HEAD PHONE

将耳机/音响插头接入本鼓背面的HEAD PHONE接口上, 使用耳机在演奏时不至妨碍他人, 特别适合个人监听及夜间学习。

五. 音频输入插孔MP3

将音乐设备插头接入本电子鼓背面的MP3接口上, 输入本鼓机所支持的音频格式。特别适合个人监听及学习。

5

Functions and features

1. The world's first Multifunctional, Portable, and Professional Drum.
2. Portable, fashionable, concise, easy to carry.
3. High quality drum sound inside, very nature and the most powerful sound.
4. Standard drum-set and the expansive pedal makes you feel absolutely same as real drum.
5. Professional demo inside, Convenient to study.
6. Style inside, Tempo adjustable, gives you the best way to study and practise.
7. Record function inside, Convenient to record your inspiration anywhere, anytime.
8. Audio input and output, excellent expandability for other device
9. Power supply by USB Cable or 2*AAA battery.

Packaging Contains

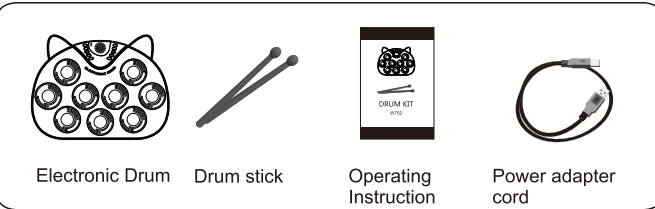

Optional parts

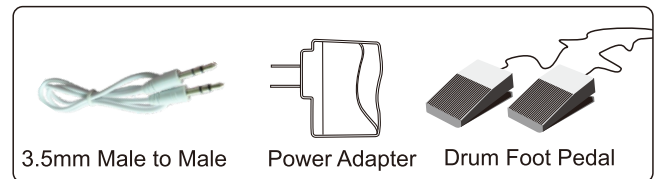

2

Schematic diagram for control panel

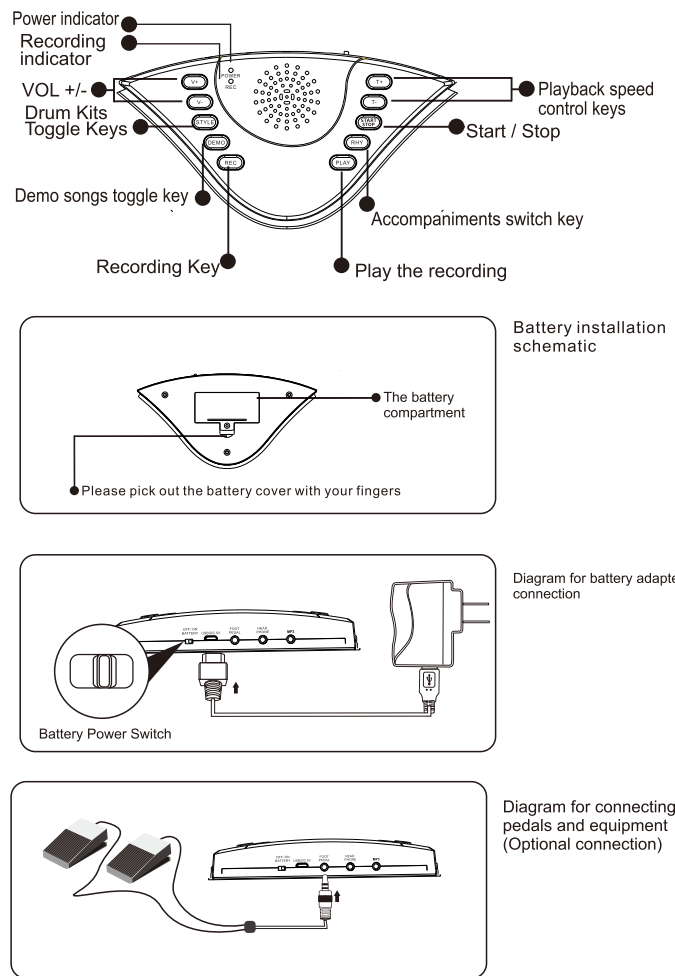

3

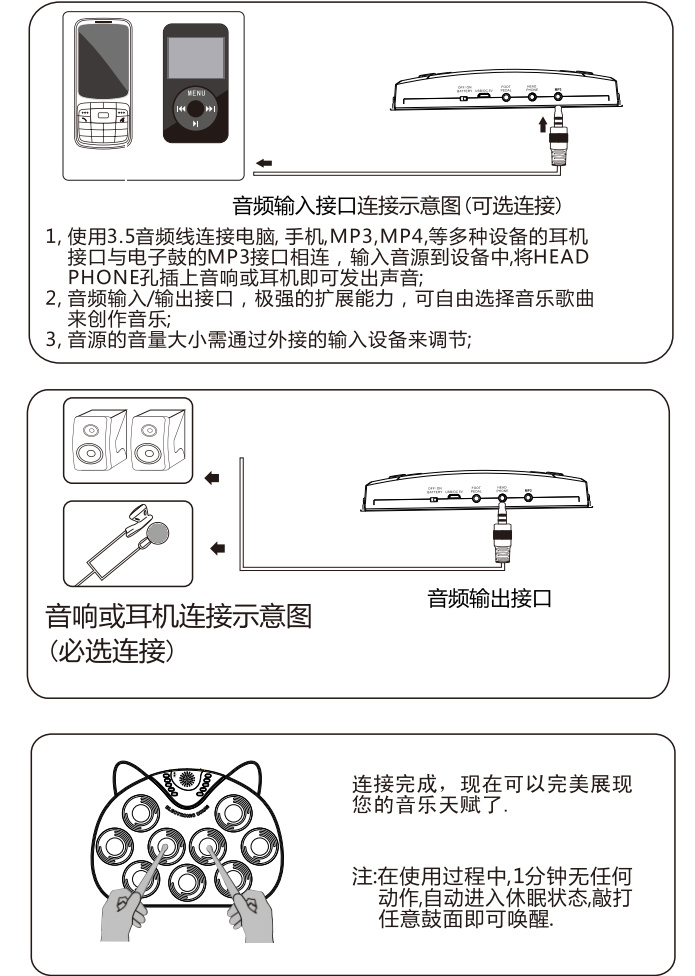

4

※ 控制面板示意图

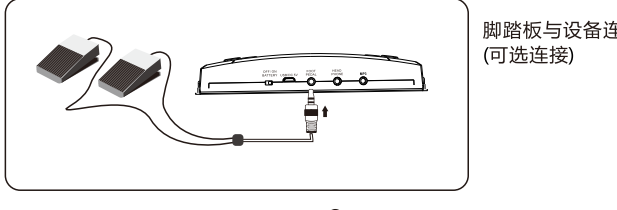
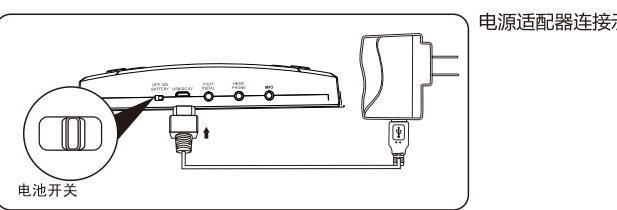
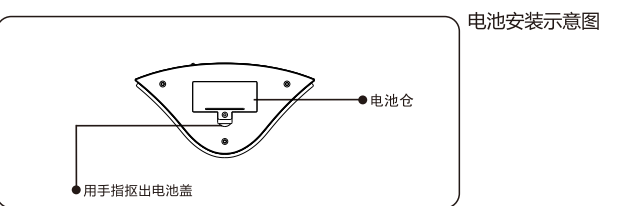
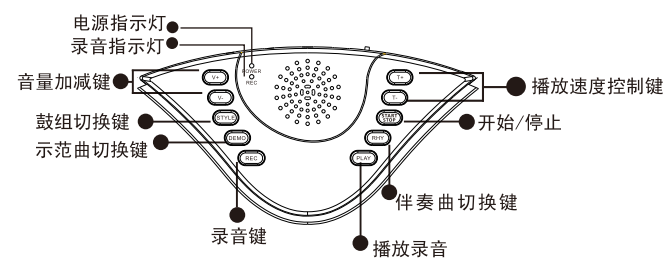

3

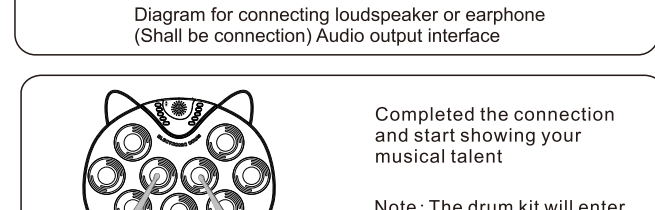
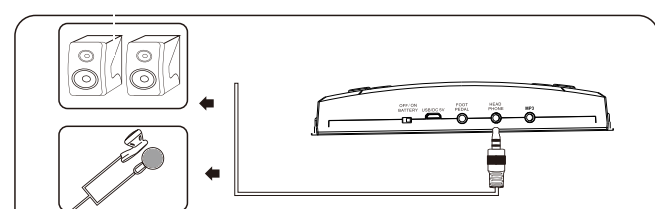
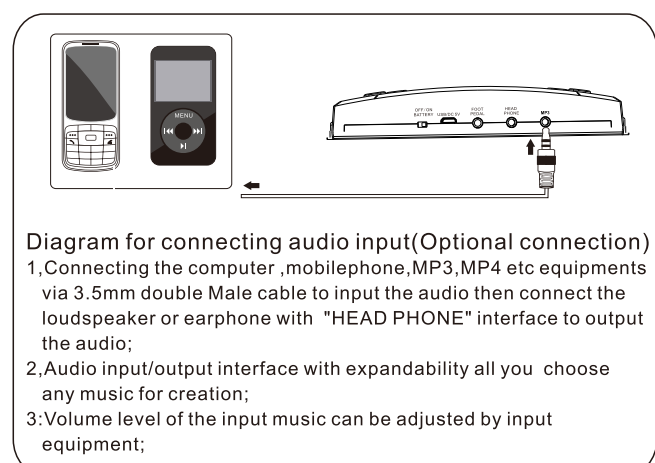

4

Basic operation

ON/OFF BATTERY

1. using the battery, use 2* AAA battery, open the battery compartment Cover to put it in and pay attention the pole
2. Switch the key ON/OFF to ON or off to control the power USB/DC5V

1. Powered by USB cable or power adapter
2. Use the external power supply the optional power adapter parameters is DC output voltage 5.0V. connect the power adapter and the external power jack DC5V (back of drum) properly.

The usb midi drum kit can use the battery. Also can use usb cable when connect computer and the optional regulated power supply Notes! (1) Please replace the battery when power is lower; (2) To avoid the battery damaging the drum please take th battery out when you do not use it for a long time;

Pedal Instruction

1. This drum kits support one pedal Hi-hat and one bass drum as, both of them were single channel input.
2. When the pedal doesn't plug into the "FOOT PEDAL" jack, Sounds will be Close hi-hat if you click "Open/close Hi-hat"; When you inject the pedal in jack ,sounds will be Close hi-hat if you step on the pedal; Sounds will be Open hi-hat while you step off.
3. Once you inject the pedal in the side FOOT PEDAL jack, one of the pedal has "Bass drum" function, the other one is functioned for "Pedal Hi-hat"

Mark: The pedal can not use mutually, for each one has its specified function

HEAD PHONE

Headphone / audio plug to the back of the drum "HEAD PHONE" interface. You would not disturb others when you wear it, especially for one who listening and learning at night..

MP3

MP3/MP4 plug to "MP3" interface (in the back of the drum), the music formats supported are particularly suitable for personal listening and learning.

Volume V+ / V-

Press the key V+ / V- to adjust the volume

Tempo T+ / T-

Press key T+ / T- to adjust the speed of demo or accompaniment

5

※ 功能与特点

1. 全球首创便携式多功能专业电子鼓;
2. 轻便时尚,简洁,易于携带;
3. 内置多组高品质鼓音源, 最真实最震撼的鼓声!
4. 标准的鼓面设置, 踏板扩展接口, 带给您真实架子鼓的享受;
5. 自带专业示范曲, 方便您欣赏、学习;
6. 自带伴奏, 可自由调节速度, 是您的最佳学习、练习伙伴;
7. 自带录音功能, 方便您随时随地记录您的音乐灵感;
8. 音频输入/输出接口, 极强的扩展能力, 可自由选择音乐歌曲来创作音乐;
9. 供电方式: USB 或者 2*AAA电池

※ 包装配件



※ 配件选配区

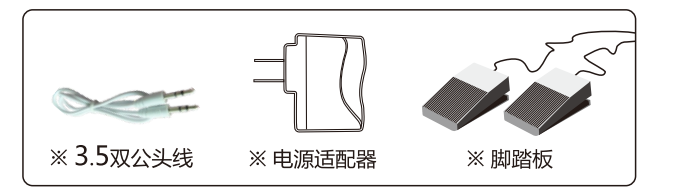

2

尊敬的客户:

感谢您选用W751电子鼓! 这种轻便, 时尚, 简洁便捷式电子鼓采用现代科技技术和电子工业创新设计, 是本公司全体人员不懈努力的成果。

我们竭诚希望它能充分发挥您的音乐天赋, 给您带来无比快乐和美妙的音乐享受。

※ 电子鼓整体外观图

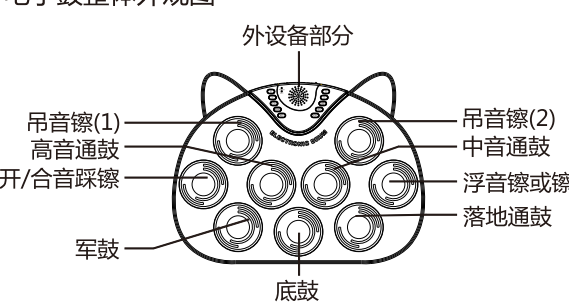

※ 控制面板端口示意图

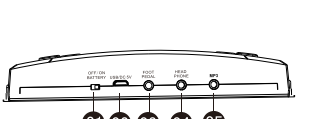

1. 电池电源开关
2. DC5V/USB接口
3. 脚踏板接口
4. 音频输出接口
5. 音频输入接口

使用产品前, 请仔细阅读说明书。

- ※ 使用前请装上7号电池或连接好电源才能工作。
- ※ 使用前请连接上音响或耳机才能发声。

1

Style Mode:

1. Press the Style button to enter the 7 different drums. press the Style button to select any style one by one.
2. When the drum enters the style mode, you play the drum and you will hear different drums.

Demo Mode:

1. Press the Demo button to enter the demo song playing status.
2. Press the Demo button to select any demo song one by one.

Record Mode:

1. Press the REC button to enter the record mode, and the REC light will flash, then the drum is ready to record notes.
2. When the drum enters the record mode, you can play the music as you like. The system will record what you have played faithfully by itself, until the planned system blocks for recording is filled (max 336 notes), and then exit this function automatically.
3. After entering the record mode, press the REC button to exit, and the REC light will go out.
4. After rerecording and system resetting, recorded notes will be renewed automatically.

Note: When DEMO/RHY is working, REC/PLAY button is not working when pressed.

PLAY Mode:

1. Press the PLAY button to replay the recorded music, REC light will flash. But this function is not available until there is not recorded.
2. When finished, the system will return to normal status automatically.
3. If you need stop playing, press REC button; But the music recorded before will disappear, and go to the rerecording status.

Rhythm Mode:

1. Press the RHY button to enter the rhythm option.
2. Press the RHY button to select any RHY preference, and the RHY will be switched among the 9 options..

START/STOP Mode:

1. Press the START/STOP button may enter the rhythm functions in the default mode.
2. When playing the demo song or rhythms, press the START/STOP button may stop playing.

6

Simple Troubleshooting

Failure phenomenon	Cause of the Failures	Remedy
Power indicator does not work	The battery is running out of power or USB cable is not inserted well	Please check the connection between power line and equipment
No sound (Headphones or Audio)	No power supply or volume is not adjusted well or earphone not connected to the right interface of our drum	Please check the level of VOL and make sure all the interface are connected well

Cautions:

1. Do not use the drum in a wet, high temperature or dusty area.
2. Keep the drum kit level when in use. Do not place the drum kit near areas with strong electric waves.
3. Do not place the heavy objects on the product, to avoid impacting of the collision.
4. Do not pull or twist the body or drum kit with 90°. It may damage the functions.
5. Do not tamper with the wiring of this product with a cutter or other sharp tools. It may damage the functions.
6. When Rolling up the drum kit after use, do not roll it too tight.

Product Specifications:

1. Size: 39(L) × 28(W) × 2.6(H)CM
2. Input voltage: USB 5V (battery: AAA × 1.5V × 2PCS)
3. Material: Silicone

7

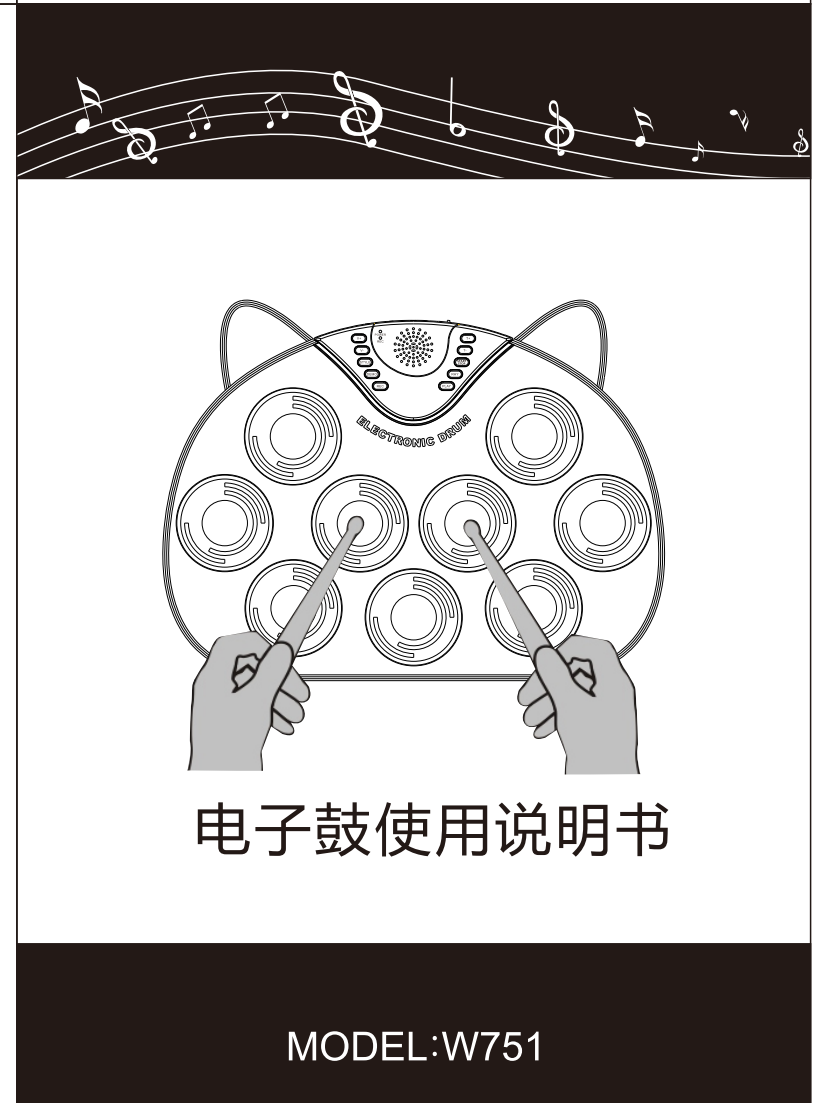

电子鼓使用说明书

MODEL:W751